

## Contents

0.0: REVISIONS NOTICES .....	1
1.0: SAFETY PRECAUTIONS.....	2
2.0: IDENTIFICATION .....	4
2.1: The product brand and type designation .....	4
2.2: Version of product .....	4
2.3: Manufacturer contact.....	4
2.3.1: Contact for technical support .....	4
3.0: PRODUCT SPECIFICATION .....	5
3.1: Range of applications intended use and general functions.....	5
3.2: Dimensions (for transport) .....	5
3.3: Specification for electricity and air .....	5
3.3.1: Power supply.....	5
3.3.2: 120v or 220v .....	5
4.0: INSTALLATION .....	6
4.1: Minimum space required.....	6
5.0: OPERATION .....	7
5.1: Turning ON and OFF the machine.....	7
5.2: Feeding clips.....	8
6.0: MAINTENANCE AND CLEANING .....	10
6.1: Preventive maintenance schedule.....	10
6.2: Cleaning.....	10
7.0: MAINTENANCE AND REPARATIONS BY TECHNICIANS FROM KLR SYSTEMS INC. ....	11
7.1: Contact information for service technicians.....	11
7.2: Contact information for technical support .....	11
8.0: LISTS OF SPARE PARTS AND CONSUMABLES .....	11
8.1: Spare parts list KLR.905.....	11
10.0: DECOMMISSIONING OF THE PRODUCT .....	12
11.0: EXPLODED VIEWS.....	12
11.1: Overview .....	12
11.2: Main assembly .....	13
11.3: Top assembly .....	14

11.4: Drive exploded .....	15
12.0: ELECTRICAL PLAN .....	16

## 0.0: REVISIONS NOTICES

2023-09-27: Corrected the spare part list (8.1).

2023-07-20: Added exploded views, electrical drawing.

2023-06-29: Document creation.

## 1.0: SAFETY PRECAUTIONS



- The equipment described in this manual is covered with fix panel (only opened with a tool) that provide protection from electrical components and most of mechanical motions. However, there is four (4) belts that can be exposed to the user. ALWAYS turn OFF the machine before approaching hands from every motion part to remove a jam, service or clean the machine. Go against this notice can result in a severe injury or death.
- Special attention was made to ensure that the operation of the machine is safe and convenient without compromising the efficiency. Keeps hands away from the mechanism that cuts the clips apart. Keep hands and clothes away from the working area of the machine.
- Use cut-resistant glove to manipulate the blades.
- If the system is linked to another machine or installed onto another machine. Lock the electrical box of the other machines before performing any maintenance on this equipment. Please refer to the local regulations and laws on locking out machinery. Go against this notice can result in a severe injury or death.
- When working on the electrical components. Disconnect the equipment at the source and use a lockout device to avoid any risk of danger. Make sure you also have the space required to complete the work to avoid any risk of danger.
- Any modifications with any aspect of the mechanical, safety, electrical design, design, or any parts connected with the equipment will void the warranty and liability of KLR Systems. If a change is required, contact KLR Systems for approval. All technical handling must be done by a qualified technician or by KLR Systems.
- KLR is not responsible for any abuse, mishandling, misuse, improper maintenance and repair by owners and users.
- Only a qualified person can repair or work with the electrical components.

Continue the next page...



# CAUTION

- Safety switches: DO NOT bypass any safety components for any reason. Violation will void all warranties and responsibility from KLR Systems. If a safety component is broken, it must be replaced before starting the machine.
- Safety panel (fix panel) or safety doors: As a safety, component does not try to remove or unscrew them unless it is necessary for a maintenance operation. If it is the only option, use a lockout device during this procedure and reassemble every single piece as it was when finished.
- When the machine is set to interlock mod, that means the KLR.950 run command and speed is controlled by another equipment. Careful when handling the equipment because it may start when you do not expect it. ALWAYS keep hand away from belts and mechanisms even when the machine is stopped.

## 2.0: IDENTIFICATION

### 2.1: The product brand and type designation

KLR.905

Manual bag closer

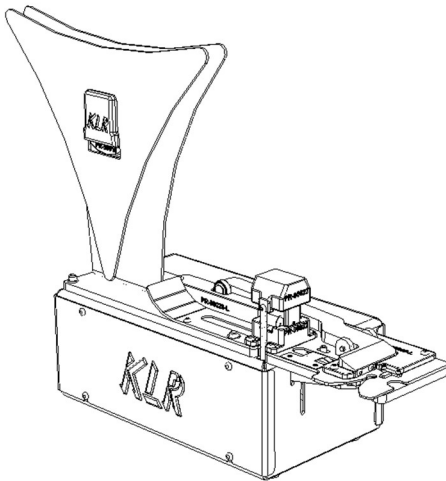

### 2.2: Version of product

Serial number: located on top of the power supply plug.

### 2.3: Manufacturer contact

KLR SYSTEMS INC. Packaging equipment manufacturer

Address: 944 rue des Hérons,

City, province, country: Saint-Pie, Québec, Canada

Zip code: J0H 1W0

Phone number: 450-388-0404

[Info@klrsystems.com](mailto:Info@klrsystems.com)

<https://www.klrsystems.com/>

#### 2.3.1: Contact for technical support

450-388-0404

[support@klrsystems.com](mailto:support@klrsystems.com)

<https://www.klrsystems.com/support>

## 3.0: PRODUCT SPECIFICATION

### 3.1: Range of applications intended use and general functions

The bag closer KLR.905 is designed to close bag tail with carboard clip. following values are subject to change:

- Feeds, prints, and cuts the clips automatically up to 40 per minutes.
- Simple loading and unloading.
- Use carboard clips.
- Unexpensive date printing method.
- Low maintenance required.
- Made of stainless steel 304.

### 3.2: Dimensions (for transport)

Height: 19 inches (if clip spool installed); Length: 21 inches; Width: 8 inches

### 3.3: Specification for electricity

This machine is intended to use these 2 possible specifications:

#### 3.3.1: Power supply

Access within 6 feet from the machine.

- 120 Volts – 2.5 Amps – 1 Phase – 50 / 60 Hertz
- 220 Volts – 1 Amps – 1 Phase – 50 / 60 Hertz

Need a 3 pins female jack power cord adapter 18AWG. Provided in the packaging with the machine:

PE-00770



#### 3.3.2: 120v or 220v

Access within 6 feet from the machine.

120v = PE-01531-15-5P-6

220v = Contact service for part number



## 4.0: INSTALLATION



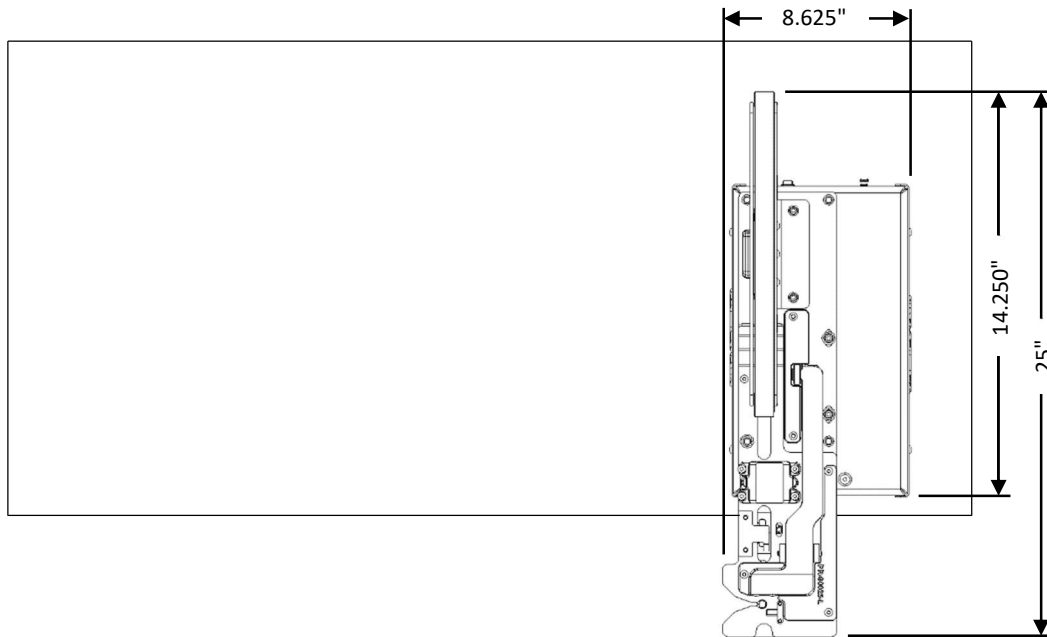

- The KLR.905 must be set on a **dry** and **even** surface.

### 4.1: Minimum space required



## 5.0: OPERATION

	<p>➤ Before using the machine, it is important that every operator of the machine and maintenance personnel take part in a training session given by KLR systems technicians.</p>
 <b>CAUTION</b>	<p>➤ ALWAYS turn OFF and UNPLUG the equipment before any maintenance procedures, cleaning, removing a jam or any other tasks that could hurt the user if the machine start promptly.</p>
	<p>➤ DO NOT leave the unit ON for an extended period without operating it.</p>

### 5.1: Turning ON and OFF the machine

In the back off the machine, there is the main power switch. Turn OFF to remove any energy in the machine.

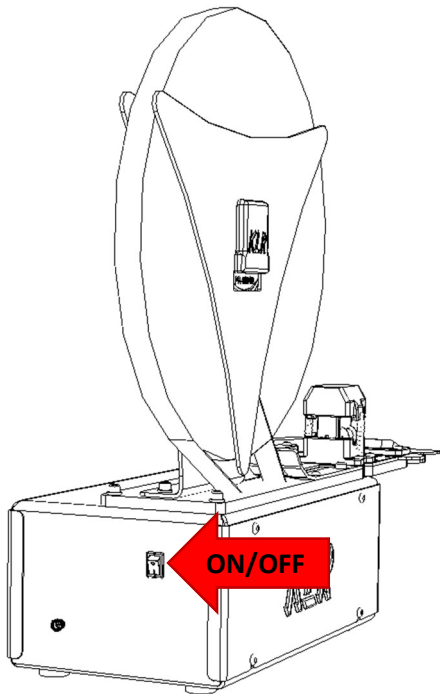



## 5.2: Feeding clips

1. Turn OFF the machine.
2. Remove the Lexan holder.

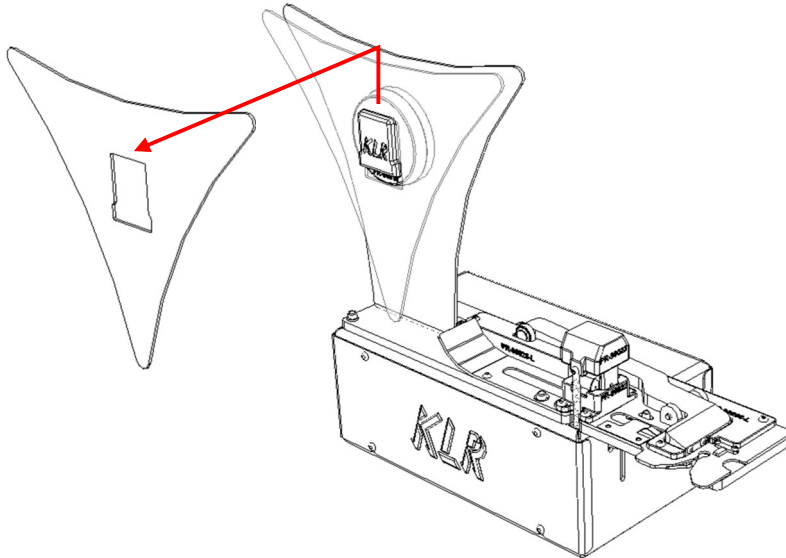

3. Insert the clip roll and taking care the opening of the clips are facing the correct side.

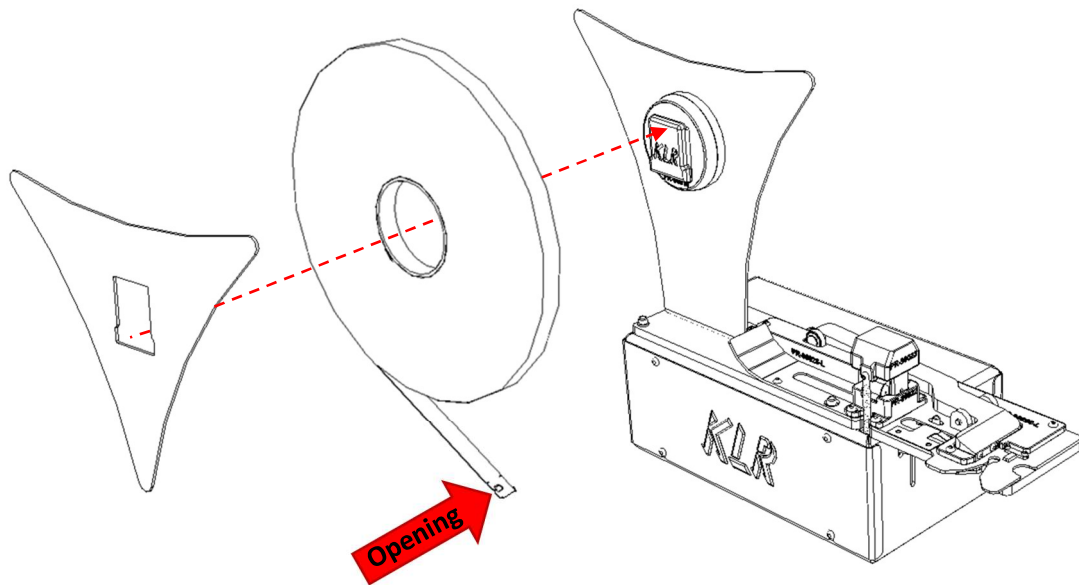

4. Feed the clip at least until this point. The clip can also be anywhere beyond this point.

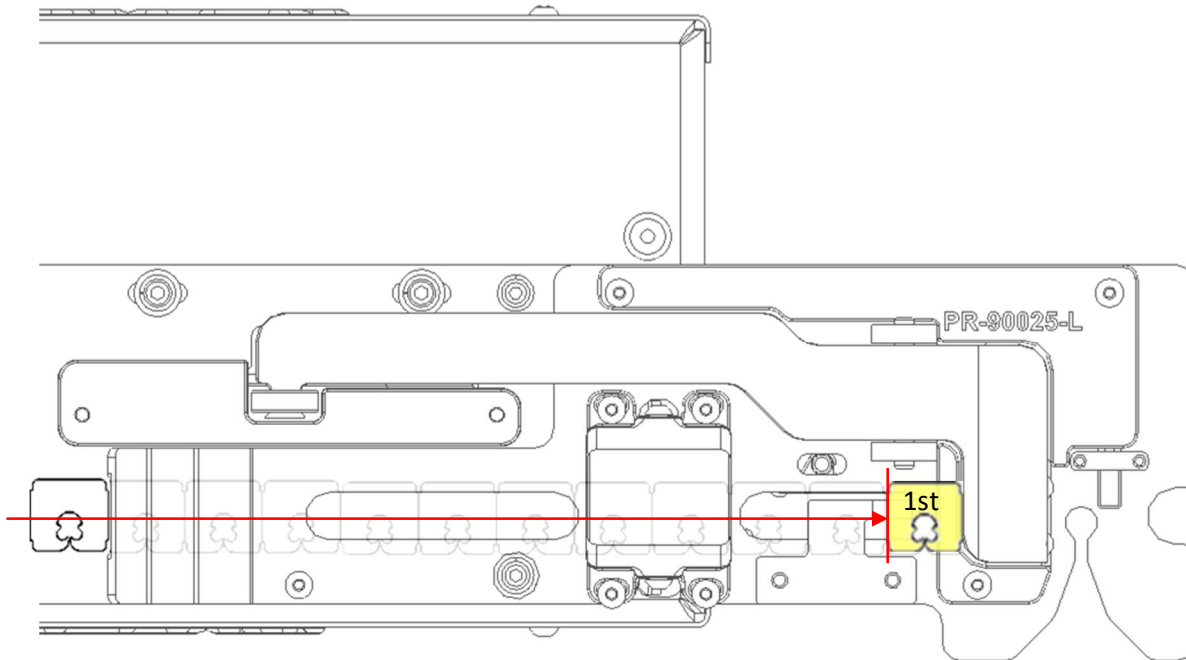

5. Turn ON the machine. Make sur the clip ends up in the correct location.

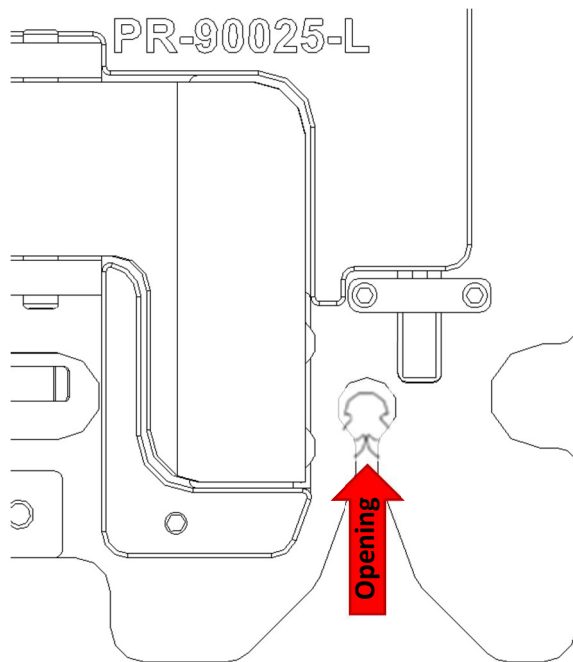

6. In case of printed clips, dispense 6 clips simply by remove them one by one. After that, the machine is ready for operation.

## 6.0: MAINTENANCE AND CLEANING

### 6.1: Preventive maintenance schedule

Here is a quick way to take care of your machine by a preventive maintenance schedule. Take note that these procedures are only advices and are subject to change. These time intervals will change according to the usage of the machine:

PREVENTIVE MAINTENANCE SCHEDULE			
Location	Procedure	Time interval	Remarks
Cutting mechanism	Replace blade	60000/+ cuts or when ragged cut	Cut-resistant glove and 5/64 Allen key required.
Printing mechanism	Check spring and printing quality	monthly	Especially on date changing, springs can be deformed if pulled up to high.
Cam / motor	Check four (4) bearings wear / replace	2 years	None.

### 6.2: Cleaning

Cleaning must be done weekly or monthly.

- Use air blowers to get rid of the dust;
- DO NOT use chemical on the sensor;
- DO NOT spray with water hose. This is NOT A WASH-DOWN machine.

## 7.0: MAINTENANCE AND REPARATIONS BY TECHNICIANS FROM KLR SYSTEMS INC.

### 7.1: Contact information for service technicians

KLR SYSTEMS INC.

944 Herons street

SAINT-PIE, QUÉBEC, CANADA

JOH 1L0

450-388-0404

[Info@klrsystems.com](mailto:Info@klrsystems.com)

<https://www.klrsystems.com/>

### 7.2: Contact information for technical support

450-388-0404

[support@klrsystems.com](mailto:support@klrsystems.com)

<https://www.klrsystems.com/support>

## 8.0: LISTS OF SPARE PARTS AND CONSUMABLES

### 8.1: Spare parts list KLR.905

**Suggested spare part list per machine for KLR.905**

Numbers	Part numbers	Quantity	Descriptions
1	PE-1517-1M	1	OCTICAL SENSOR, THROUGH BEAM, WIRE LEADS
2	P12-00085	1	TRIGGER SWITCH NO/NC
3	OS-108	2	SPRINGS
4	PR-90024	5	MODIFIED BLADE
5	PM-01710-FR	1	FRENCH DATE PRINTER
	PM-01710-EN		ENGLISH DATE PRINTER
6	PM-01710-INK	1	INK BOTTLE 28ml
7	PM-01710-PAD	2	INK PAD REPLACEMENT

## 10.0: DECOMMISSIONING OF THE PRODUCT

It is advisable to plan a tour of KLR to reinstall the equipment after a prolonged deactivation or a move, destruction, recycling, disposal.

## 11.0: EXPLODED VIEWS

### 11.1: Overview

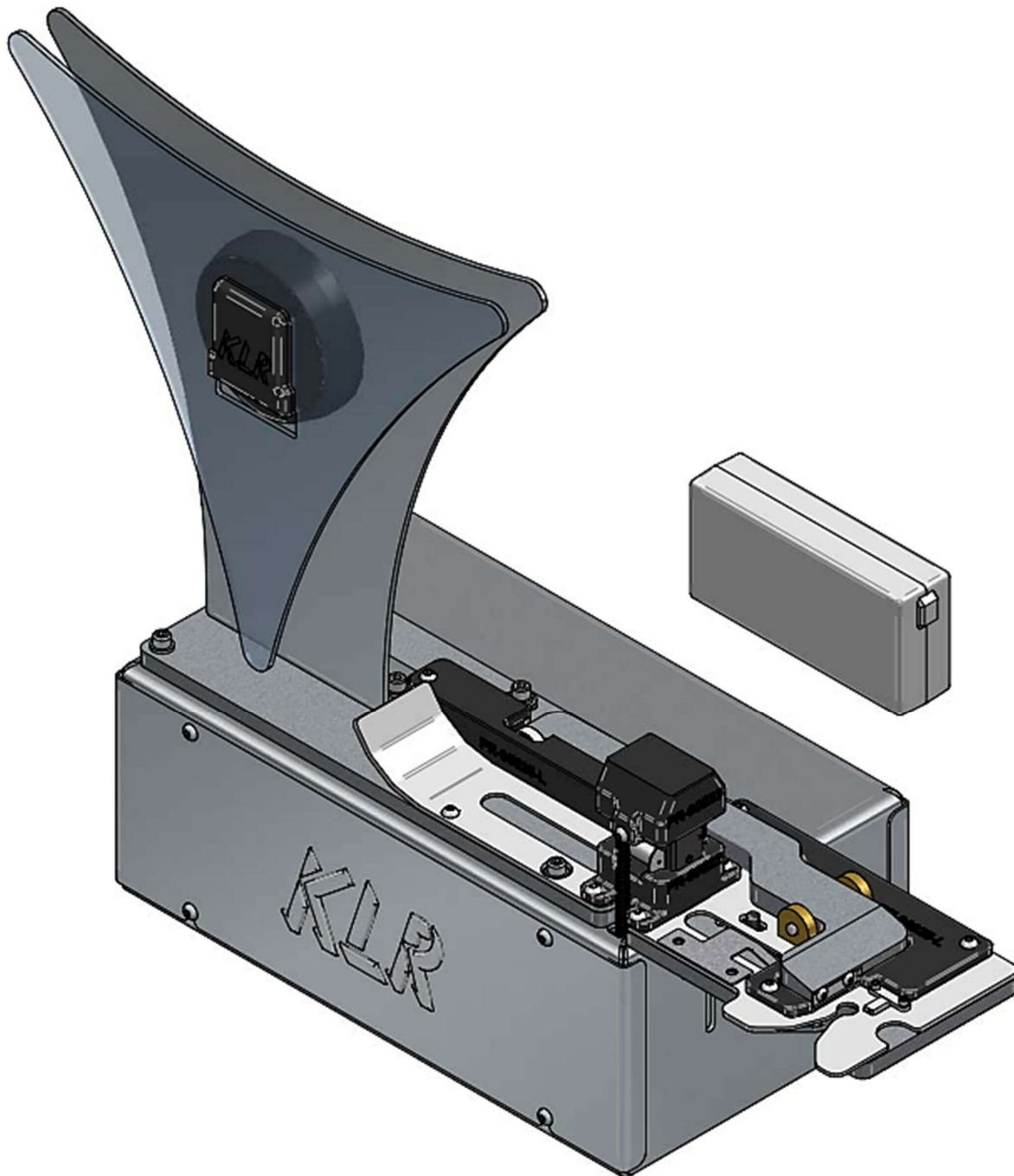

## 11.2: Main assembly

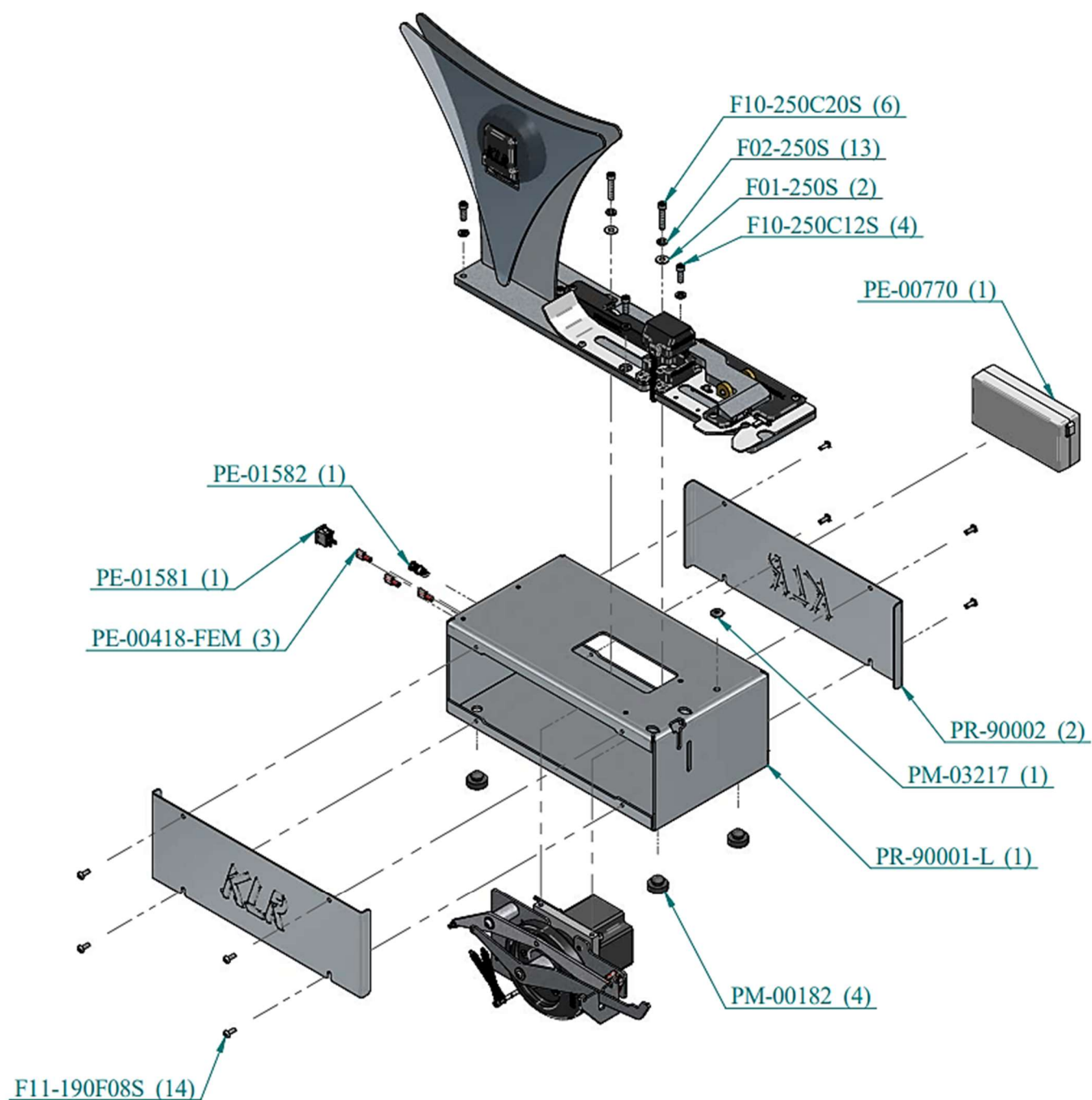

### 11.3: Top assembly

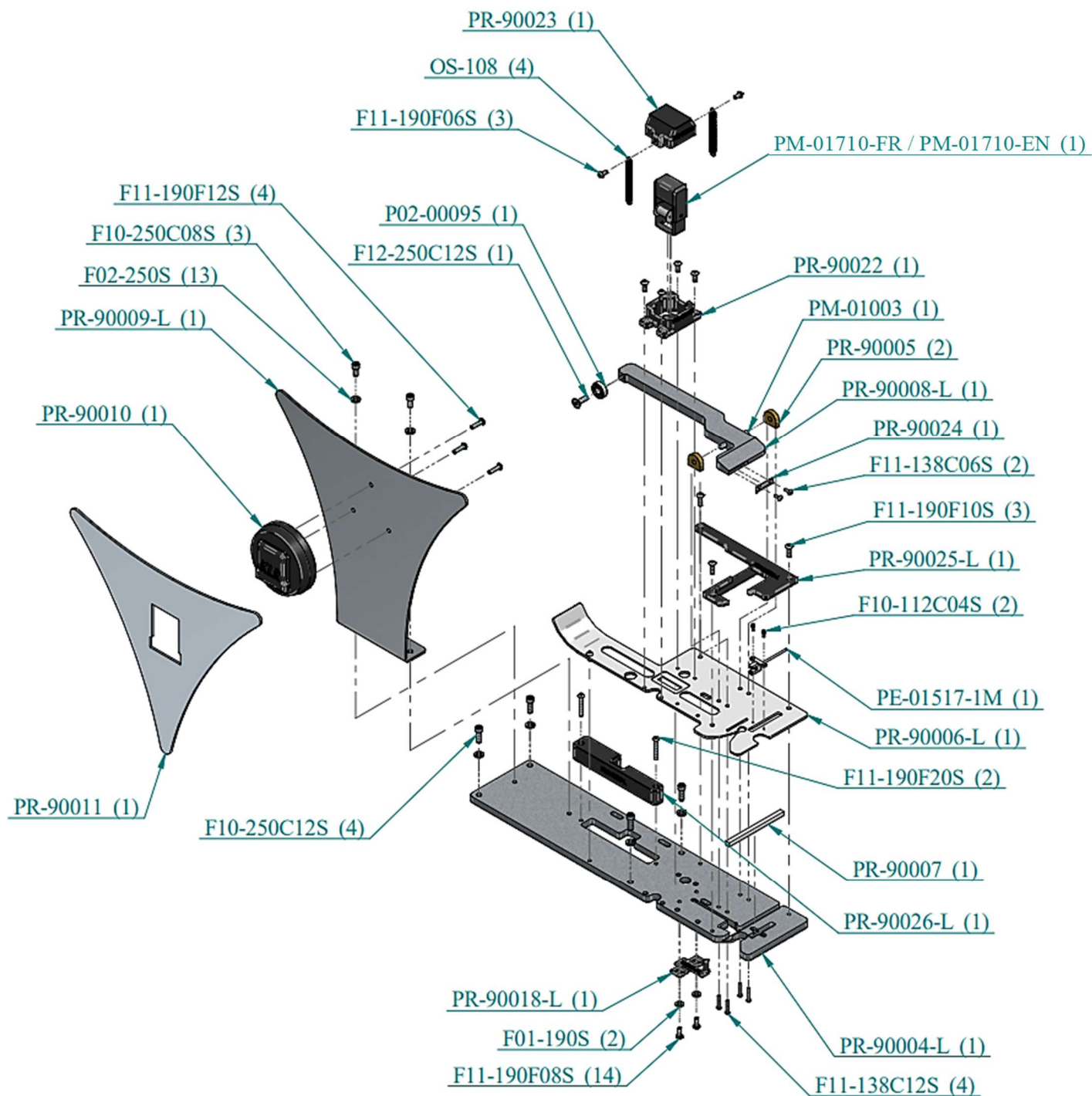



## 11.4: Drive exploded

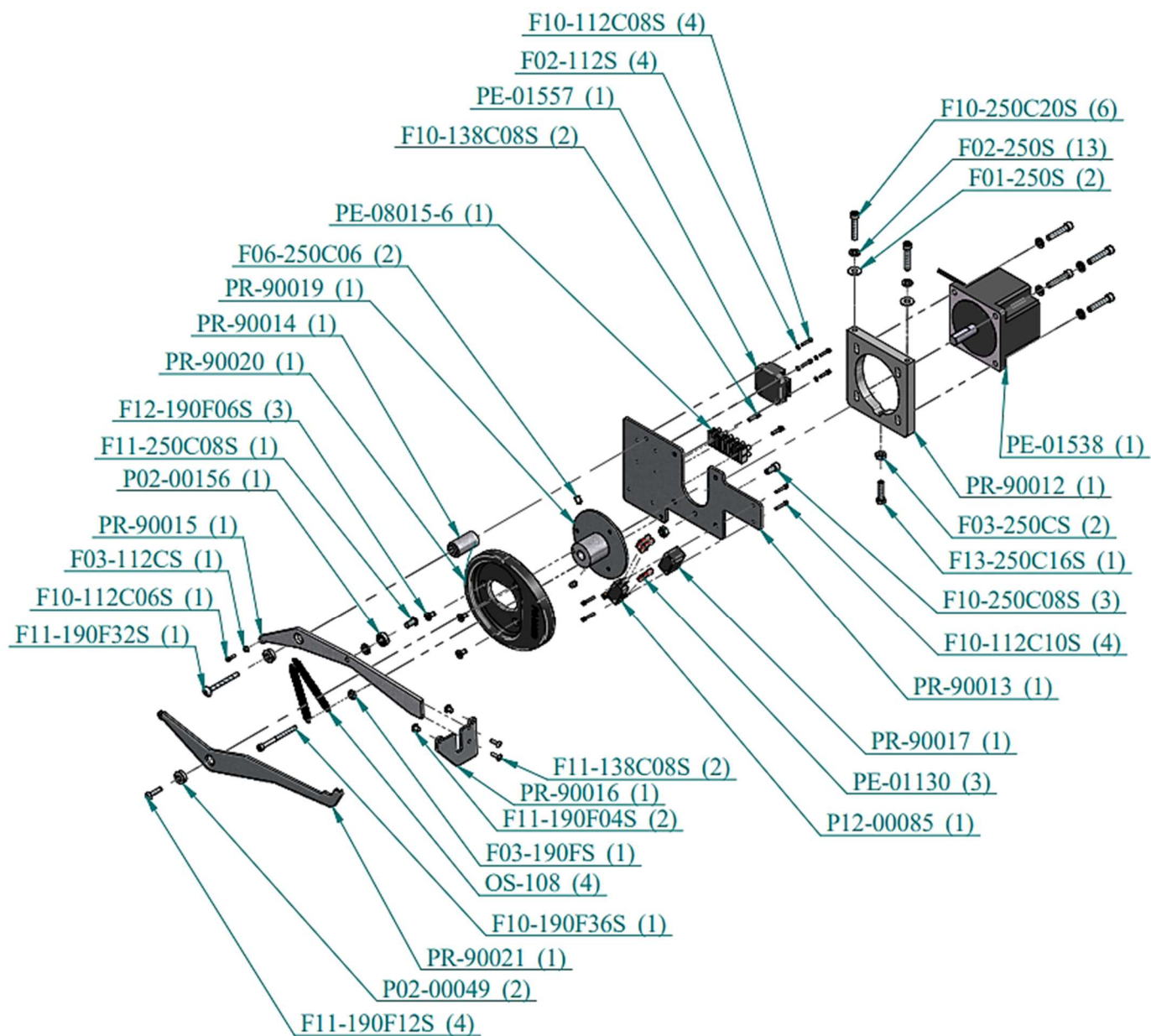



## 12.0: ELECTRICAL PLAN

Revision: KLR.950-M.E1

